

SENTINEL™ A50

Revolutionary high performance automatic welding helmet



Years of welding have trained you to know exactly what you need in a hood: crucial comfort, large lens, and next generation technology. Every special operation needs special equipment that gets the job done, and when it comes to your helmet, SENTINEL™ is worn by the best.

- Revolutionary Shell Design. High Impact Resistance Nylon
- Halo™ Headgear. Ergonomic, infinitely-adjustable 5 point head gear provides extreme comfort and balance. Low-profile design, central pivot point allows for maximum head clearance while helmet is in the up position.
- 100 x 60mm 1/1/1/2 – 5-13 ADF
- Externally activated Grind Button. Shade 3 Grind Mode
- Colour touch screen control panel

Visit esab.com for more information.



*Halo™ comfort 5 point harness
(Front view)*

Industry

- Industrial and General Fabrication



High optical class ADF, with colour touch screen interface

SENTINEL™ A50

Specifications

Cartridge Dimensions	133 x 114 x 9 mm
Viewing Area	100 x 60 mm (3.93" x 2.36")
Lens Shade	DIN 5-8/9-13
Power Supply	Solar cell plus battery replaceable. (2*CR2450 lithium). Alerts when low battery.
Sensors	4
Switch Time	1/25,000 s. from Light to Dark
Classification	1/1/1/2
Standards	DIN plus, CE, EN175, EN 379, EN166, ANSI Z87.1, CSA Z94.3, AS/NZS 1338.1
Weight	640 g (1.4 lbs.)

Ordering Information

Sentinel A50	0700000800
--------------	------------

Wear and Spare Parts

1	Front Cover Lens Clear	0700000802
1	Front Cover Lens Amber	0700000803
2	Sentinel Helmet Shell	0700000804
3	Auto-Darkening Filter (Incl. 2 x CR2450 lithium battery)	0700000806
4	2 x CR2450 lithium battery	0700000807
5	Inside Cover Lens	0700000808
6	Headgear Assembly (Including Sweat Bands)	0700000809
7	Front Sweat Band	0700000810
8	Headgear	0700000811
9	Rear Sweat Band	0700000812

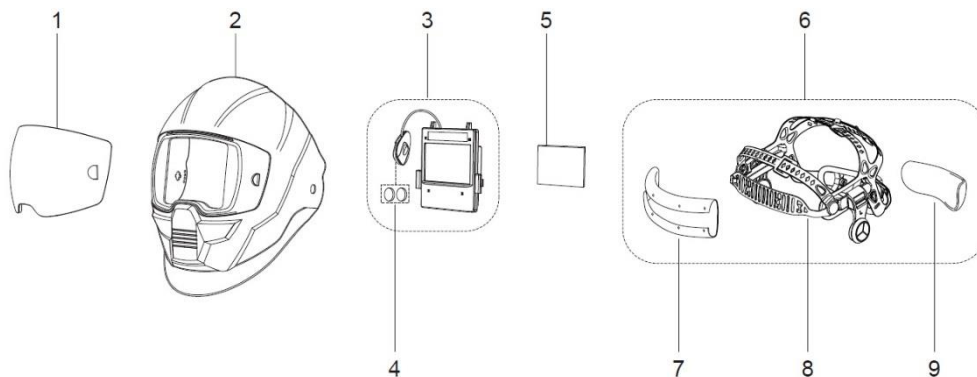

ESAB / esab.com

